



EXTRA HEAVY DUTY MONSTER CART

With Removable Sides



Owners Manual Model MH1100-02

- Important Safety Instructions
- Assembly Instructions
- Parts and Hardware Identification

- **Warning: Not for recreational use - persons should never ride in cart**
- **Warning: Do not tow cart in excess of 5 mph - never tow behind car or truck**
- **Warning: Not for high speed or highway use**

CAUTION: Read, understand and follow ALL instructions before using this product.

Tricam
7677 Equitable Drive
Eden Prairie, MN 55344
1-800-867-6763
www.tricam.com

IMPORTANT SAFETY INSTRUCTIONS

1. **READ ALL INSTRUCTIONS CAREFULLY BEFORE USE.** If you do not understand these instructions, need clarification or further explanation, please call our toll free answer line for assistance at **1-800-867-6763** Monday through Friday 8:00 a.m. until 5:00 p.m. CST.
2. Do not load cart with more than 1,500 lb (680 kg).
3. Do not allow children to use the cart unsupervised. This cart is not a toy.
4. Always distribute payload evenly over surface of bed.
5. Do not load any items on top of the panels, remove panels when oversized objects are to be loaded onto the cart .
6. If any parts become damaged, broken or misplaced, do not use the cart until replacement parts can be obtained.
7. Do not operate or use on objects that can cause damage to the pneumatic tires or tubes.
Do not inflate tires more than 30 psi (2.06 BAR).
8. **SAVE THESE INSTRUCTIONS.**

ASSEMBLY INSTRUCTIONS

Your cart requires assembly. Account for all parts and hardware before beginning assembly. If any parts are missing, damaged or if you have questions or need additional instructions, **DO NOT RETURN THIS PRODUCT TO THE RETAILER**, call the manufacturer at **1-800-867-6763**.

Tools required for assembly: Metric Socket Set, Wrenches and pliers.

STEP 1

Lay the base upside down on the ground. Use the cardboard from the carton to help not scratch the finish or the work surface.

STEP 2

The angled support brackets have been pre-assembled to the base of the cart. Pivot them up so that they are at a 75 degree angle pointing towards the outside edge of the base and tighten the lock nuts. Do not over-tighten the lock nuts in this step. You will want to be able to move the angled brackets back and forth slightly for the next step.

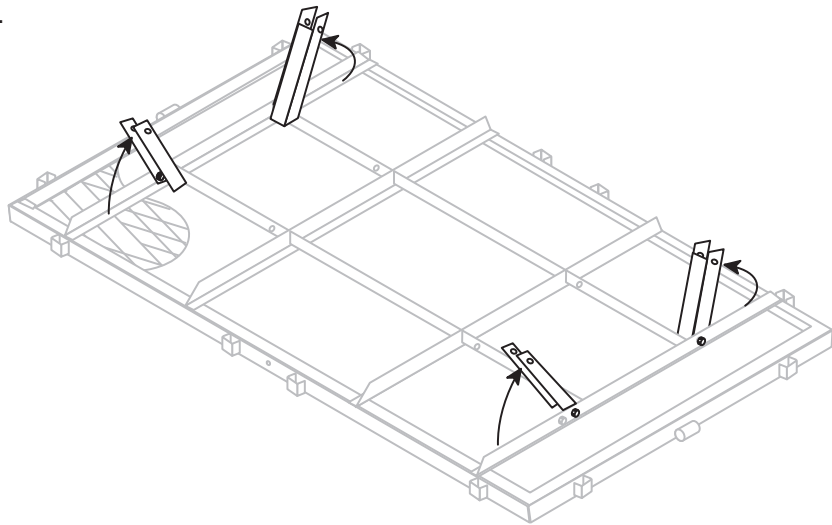

STEP 3

Attach the front axle assembly and front struts to the angled support brackets using the 10x60mm bolts (2), 10mm lock nuts (2), and 10mm washers (2).

Attach the front strut to the base using 10x20mm bolts (2), 10mm lock nuts (2), and 10mm washers (2).
Tighten securely

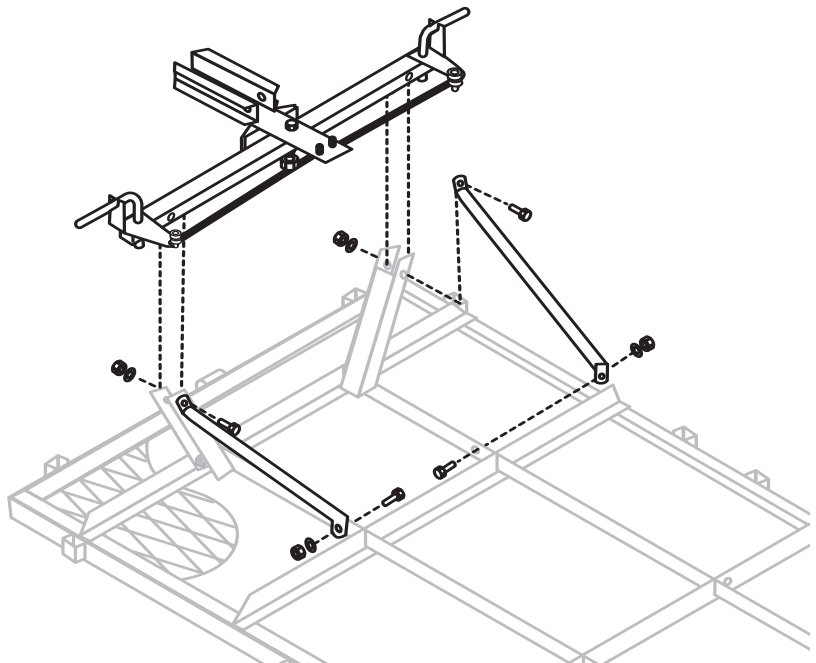

STEP 4

Attach the rear axle assembly and rear struts to the angled support brackets using the 10x60mm bolts (2), 10mm lock nuts (2), and 10mm washers (2).

Attach the rear strut to the base using 10x20mm bolts (2), 10mm lock nuts (2), and 10mm washers (2). Tighten securely.

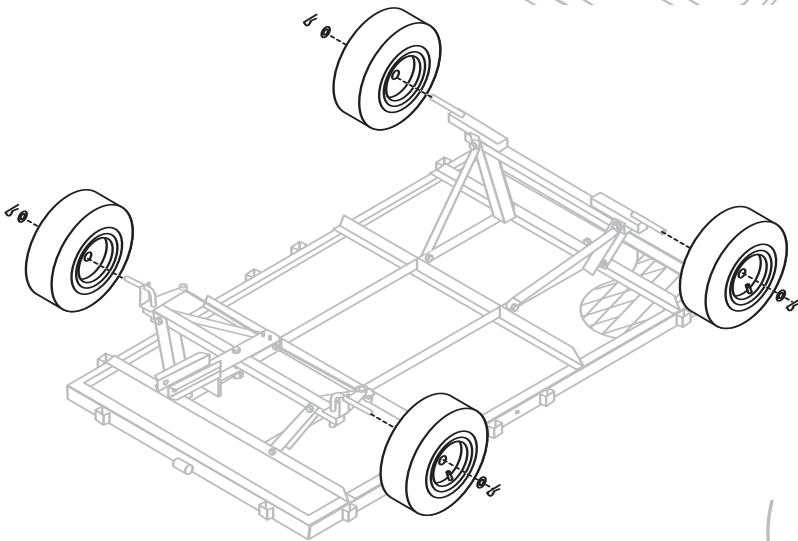
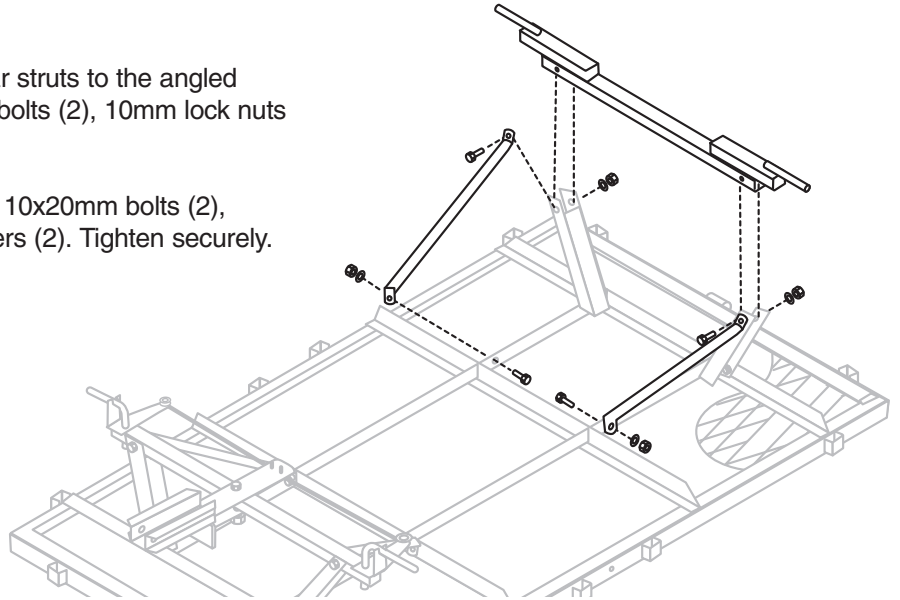

STEP 5

Attach the wheels onto the axles of each of the front and rear brackets. Place the 20mm washers (4) onto the axles on the outside of each wheel. Insert the large cotter pins (4) through the holes at the end of each axle. Be sure to bend one side of the cotter pin to keep it from falling back through the hole in the axle.

STEP 6

Install the trailer hitch into the front bracket using a 12x60mm bolt (1), 12mm washer (1), and 12mm lock nut (1). The bolt should be tight however the trailer hitch should be able to move up and down freely.

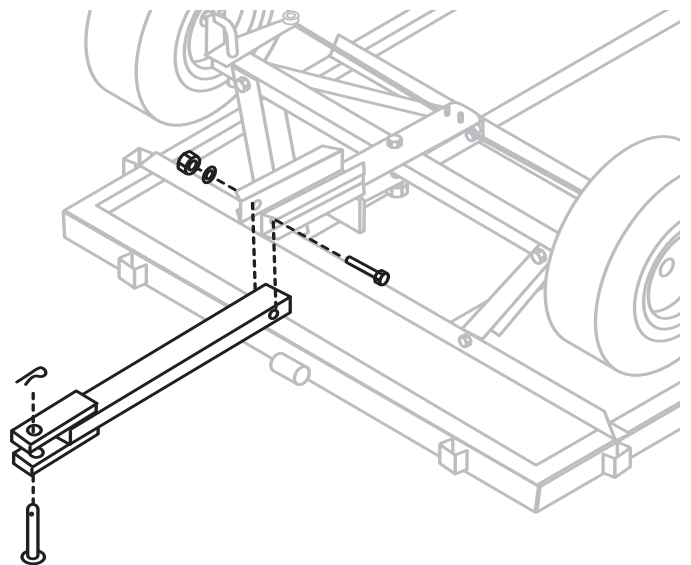

STEP 7

Turn the unit upright onto its wheels for the remaining steps. Use two people to perform this step, being careful not to lose control of the cart while turning it over. The best way to do this is to flip it over from side to side.

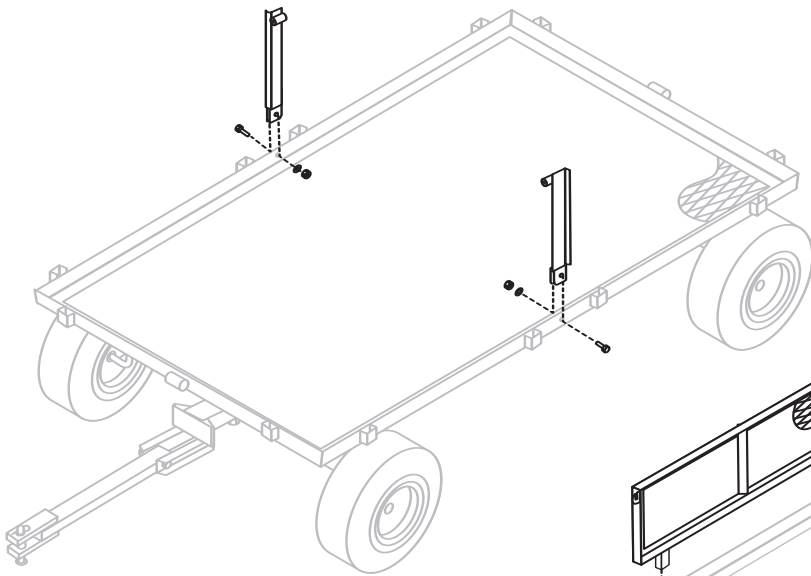

STEP 8

Attach the side panel brackets to the base of the cart using 8x20mm bolts (2), 8 mm washers (2) and 8 mm lock nuts (2). The circular tube at the top of the bracket should face the inside of the cart.

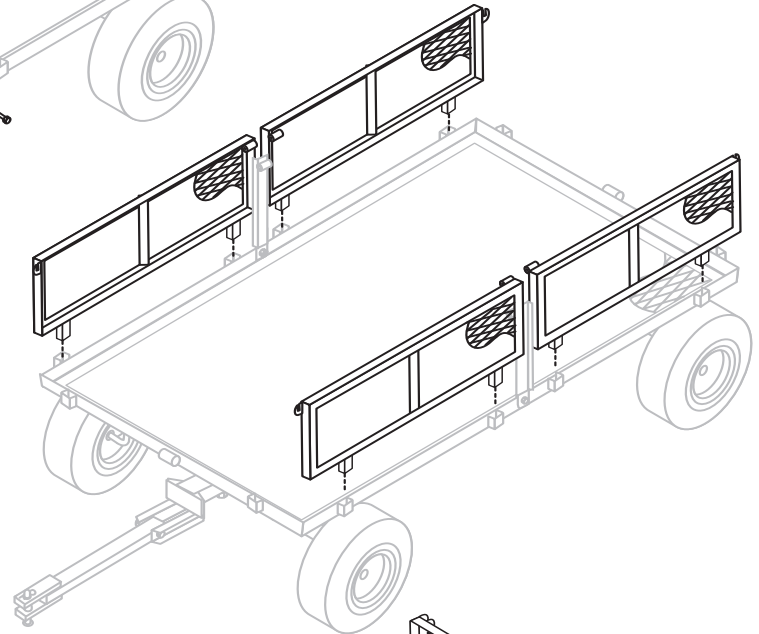

STEP 9

Assemble the four side panels by inserting the stakes on each panel into the brackets on the base of the cart. When installing the side panels to the base, make sure that the stakes for attaching the panels are to the outside of the cart. Also, make sure that the notches for the locking mechanisms are located in the corners of the cart.

STEP 10

Insert the 100mm pins (2) through the holes in the side panels and the side panel brackets. Once the pins are fully inserted, attach the clips onto the end of the pins.

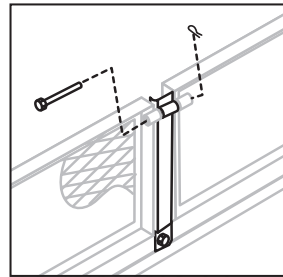

STEP 11

Assemble the front and rear panels. First remove the fence assembly pins from the base of the cart. Insert the stakes on the panels into the brackets on the base. Secure the panels by re-inserting the fence assembly pins (2) through the stake and base. Make sure that the stakes for attaching the panels are to the outside of the cart. Also make sure the lock handles in the corners are located to the outside of the cart.

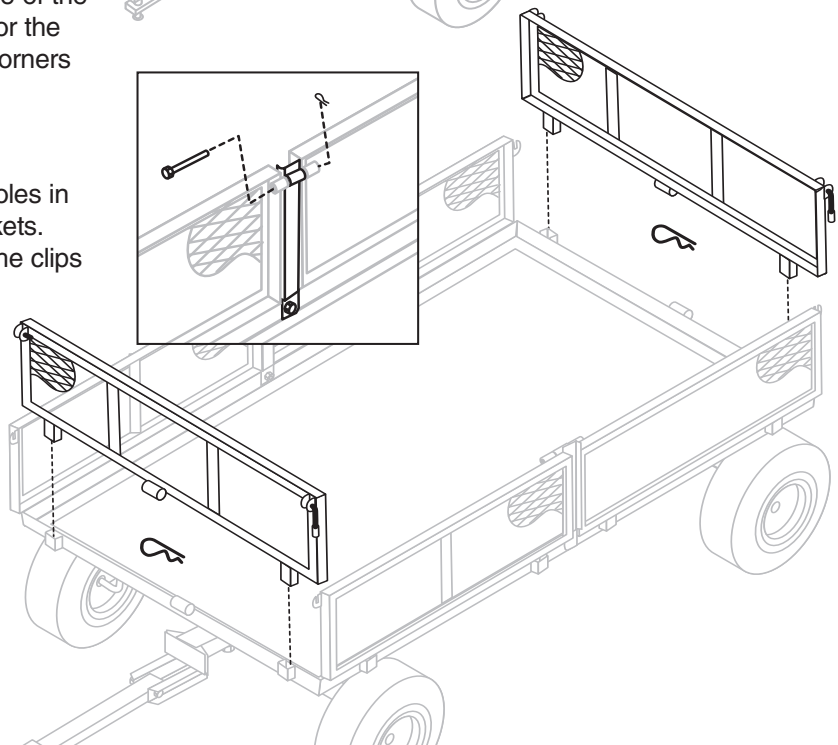

STEP 12

Attach the front and rear panels to the side panels by rotating the lock handles into place. Once all panels are locked together in the upright position, tighten the 8mm lock nuts on the lock handles for smooth operation without being overly tight.

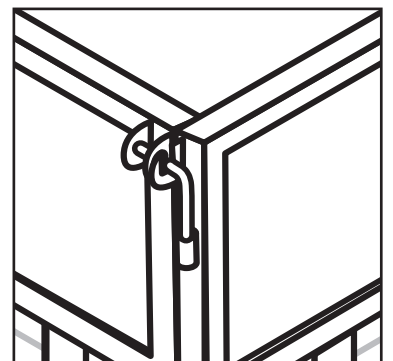
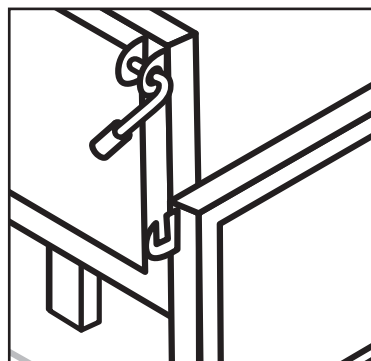

EXPLODED DRAWING FOR ASSEMBLY

MAIN FRAME PARTS

- (1) Base - (1)
- (2) Side Panels (4)
- (3) Front Panel (1)
- (4) Rear Panel (1)
- (5) Side Panel Brackets (2)
- (6) 15in (38.1cm) Wheels (4)
- (7) Front Axle Assembly (1)
- (8) Rear Axle Assembly (1)
- (9) Front and Rear Struts (4)
- (10) Trailer Hitch (1)

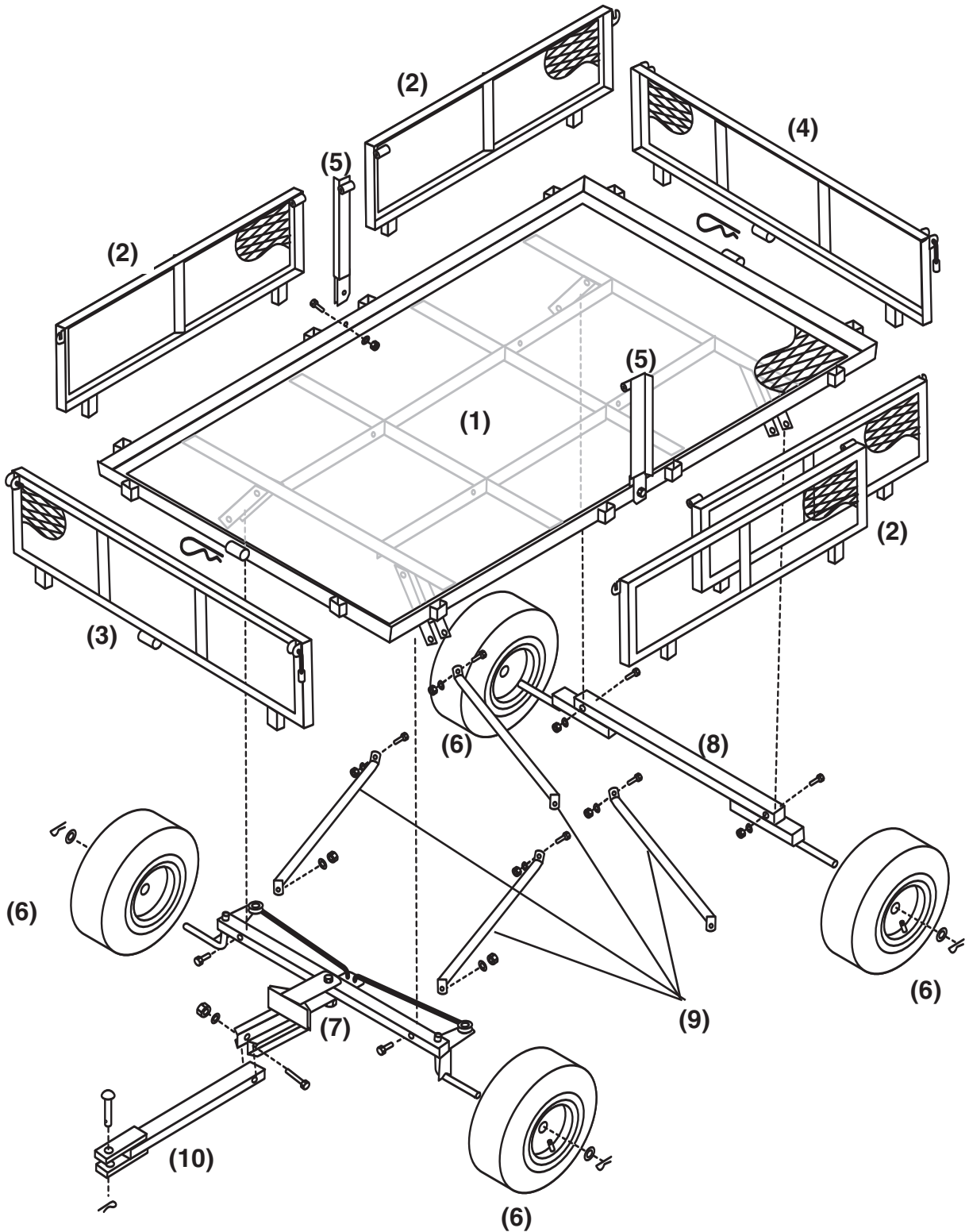

PARTS AND HARDWARE IDENTIFICATION



10x20mm Bolt – (4)



10x60mm Bolt – (4)

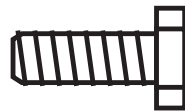

8x20mm Bolt – (2)

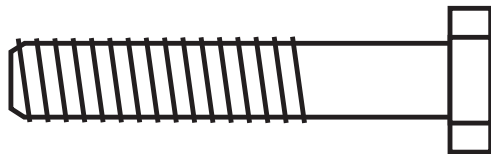

12x60mm Bolt – (1)



10mm Lock Nuts – (8)



8mm Lock Nut – (2)



12mm Lock Nut – (1)



8mm Washer – (2)



10mm Washer – (8)



100mm Pin – (2)

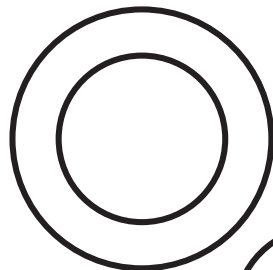

12mm Washer – (1)



20mm Washers – (4)



Clips – (2)



Large Cotter Pins – (4)