



Plastic Dump Cart

With Removable Toolbox



Owners Manual

Model MH2125

- Important Safety Instructions
- Assembly Instructions
- Parts and Hardware Identification

CAUTION: Read, understand and follow ALL instructions before using this product.

For product inquiries:
Tricam Industries Asia Ltd.
7677 Equitable Drive
Eden Prairie, MN 55344
800-867-6763
www.tricam.com

IMPORTANT SAFETY INSTRUCTIONS

1. **READ ALL INSTRUCTIONS CAREFULLY BEFORE USE.** If you do not understand these instructions, need clarification or further explanation, please call our toll free answer line for assistance at **1-800-867-6763**
2. Do not load Cart with more than 1000 lbs. (544 kg). Do not use the dumping feature of the Plastic Dump cart with more than 400 lbs. (181 kg).
3. Do not allow children to use the Cart unsupervised. This Cart is not a toy.
4. Always distribute payload evenly over the surface of the bed.
5. Do not load any items on the top edges of the plastic tray.
6. If any parts become damaged, broken, or misplaced, do not use the Cart until replacement parts can be obtained.
7. Do not operate or use on objects that can cause damage to the pneumatic tires or tubes.
Do not inflate tires to more than 32 PSI.
8. **SAVE THESE INSTRUCTIONS!**

ASSEMBLY INSTRUCTIONS

Your cart requires assembly. Account for all parts and hardware before beginning assembly. If any parts are missing, damaged, or if you have questions or need additional instructions, **DO NOT RETURN THIS PRODUCT TO THE RETAILER**, call the manufacturer at **1-800-867-6763**.

Tools required for assembly: standard screwdriver, phillips screwdriver and socket set (or two adjustable wrenches).

Refer to the exploded drawing and the parts list on the following pages during assembly.

Step 1

Assemble the rear support assembly to the frame support using (4) 10mm bolts, 10mm washers, and 10mm lock nuts, and using (2) 8 x 20mm frame support bolts, 8mm washers, and 8mm lock nuts.

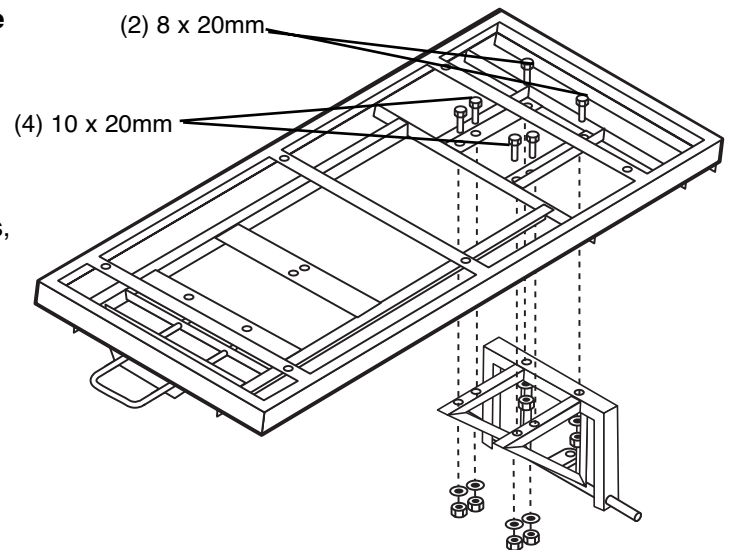

Step 2

The front support assembly is mostly pre-assembled at the factory. Please make sure all bolts and nuts assembled at the factory are tight.

- A. Align the holes of the axles with the steering link connector on the front support assembly. Insert (2) 6mm shoulder bolts and attach with 6mm washers and 6mm lock nuts.
- B. Attach the front support assembly to the frame support using (4) 8 x 20mm frame support bolts, 8mm washers, and 8mm lock nuts.

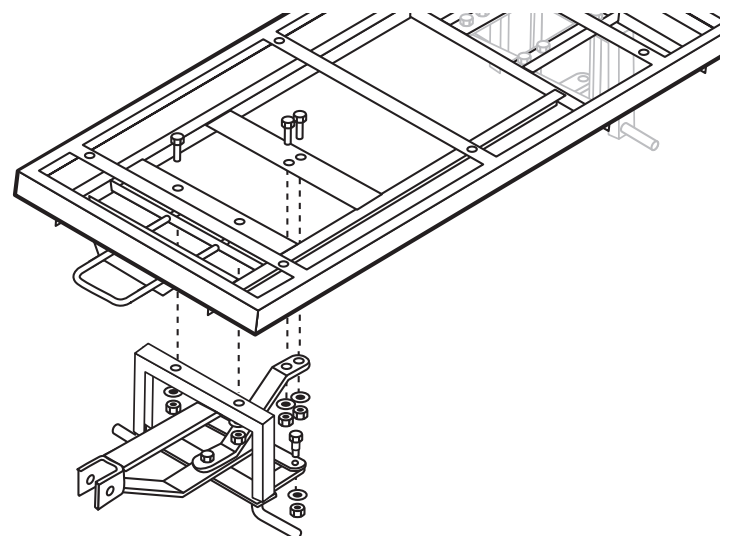

Step 3

Attach the completed frame support assembly from the previous steps to the plastic bed. Align all of the holes in the frame support assembly and the bed, and attach using (6) 8 x 30mm bolts, 8mm washers, and 8mm lock nuts.

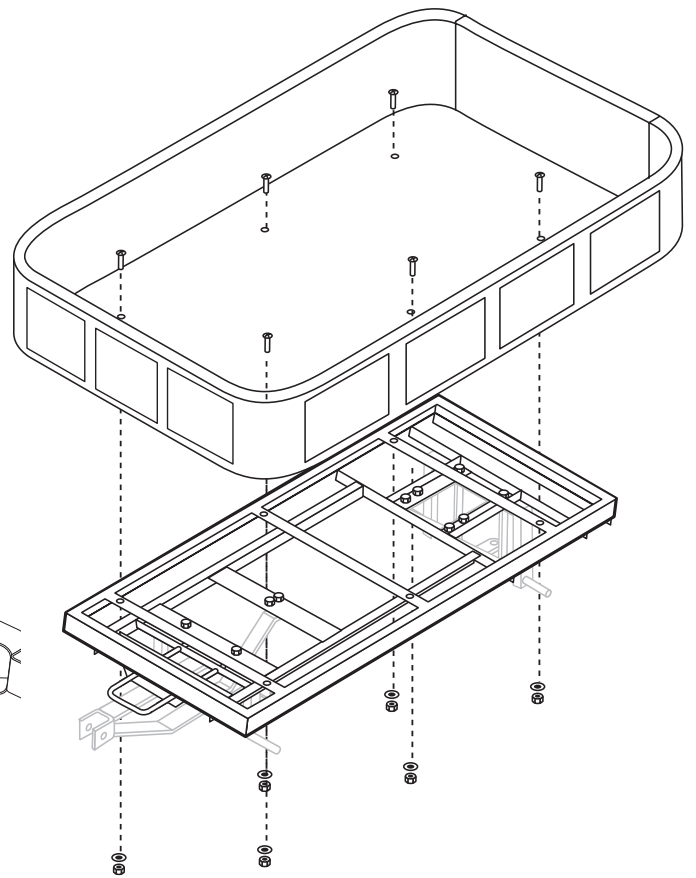

Step 4

Slide the (4) wheel spacer bushings over the axles. Place the wheels over the axles with the valve stems facing out. Attach the wheels to the axles using the (4) 12mm washers and 12mm lock nuts.

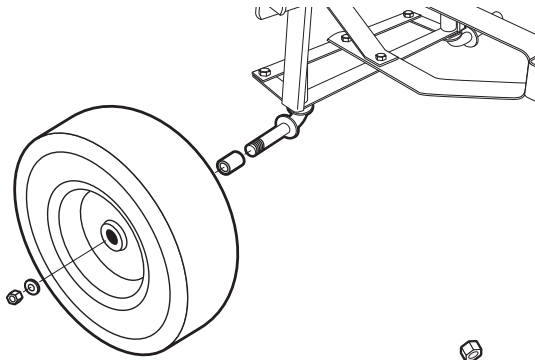

Step 5

Attach the handle to the frame support assembly using the plastic coupling, the 8 x 60mm bolt, 8mm washer, and 8mm lock nut.

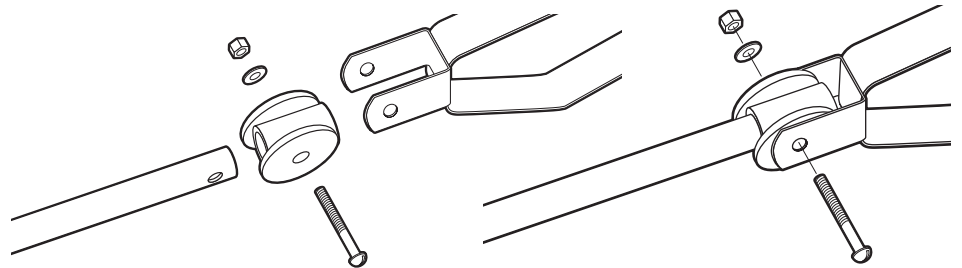

USING THE DUMPING FEATURE

To operate the dumping feature, pull the dumping release handle outward to release the plastic bed from the locking mechanism. Lift on the bed handle to rotate the cart upward into the dumping position.

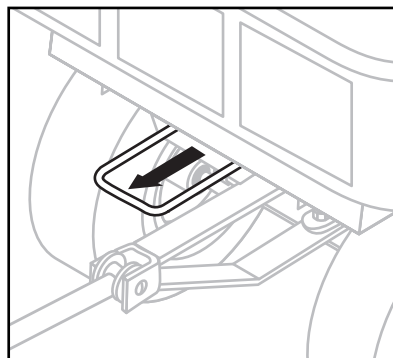

RETURNING THE PLASTIC BED TO THE LOWERED POSITION

Rotate the plastic bed back down to the lowered position. Make sure the dumping release handle is locked into place when the cart is in the lowered position.

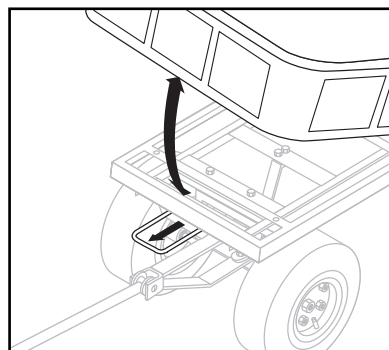

SWIVEL HANDLE INSTRUCTIONS

Step 1

Remove clips and cotter pins.

Step 2

Rotate the handle and insert cotter pin.

Secure by attaching the clip.

Step 3

The second cotter pin is used to attach the handle to the trailer hitch.

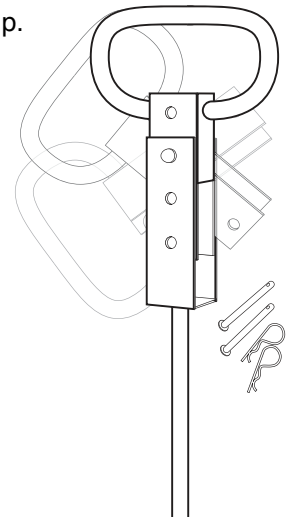

PARTS AND HARDWARE IDENTIFICATION



HARDWARE PACKAGE
(10) 8 X 20mm Frame Support Bolts - 6

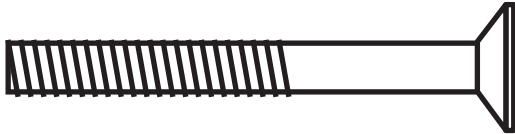

(11) 8 X 50mm Bolts - 6



(12) 8 X 60mm Bolt - 1



(13) 8mm Washers - 13



(14) 8mm Lock Nuts - 13

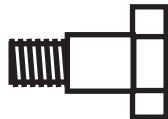

(15) 6mm Shoulder Bolts - 2



(16) 6mm Washers - 2



(17) 6mm Lock Nuts - 2

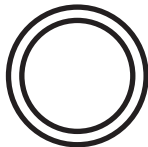

(18) Wheel Spacer
Bushings - 4

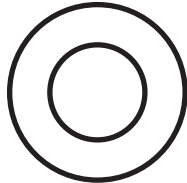

(19) 12mm
Washers - 4



(20) 12mm Lock
Nuts - 4



(21) Handle Pin - 2



(22) Handle Clevis Pin - 2

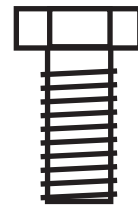

(23) 10 X 20mm Frame
Support Bolts - 4



(24) 10mm Washers - 4



(25) 10mm Lock Nuts - 4

EXPLODED DRAWING FOR ASSEMBLY

PARTS

- (1) Plastic Bed - 1
- (2) 13" x 5" Pneumatic Wheels - 4
- (3) Frame Support - 1
- (4) Front Support Assembly - 1
- (5) Rear Support Assembly - 1
- (6) Handle - 1
- (7) Plastic Coupling - 1
- (8) Tool Box - 1
- (9) Tool Box Rack - 1

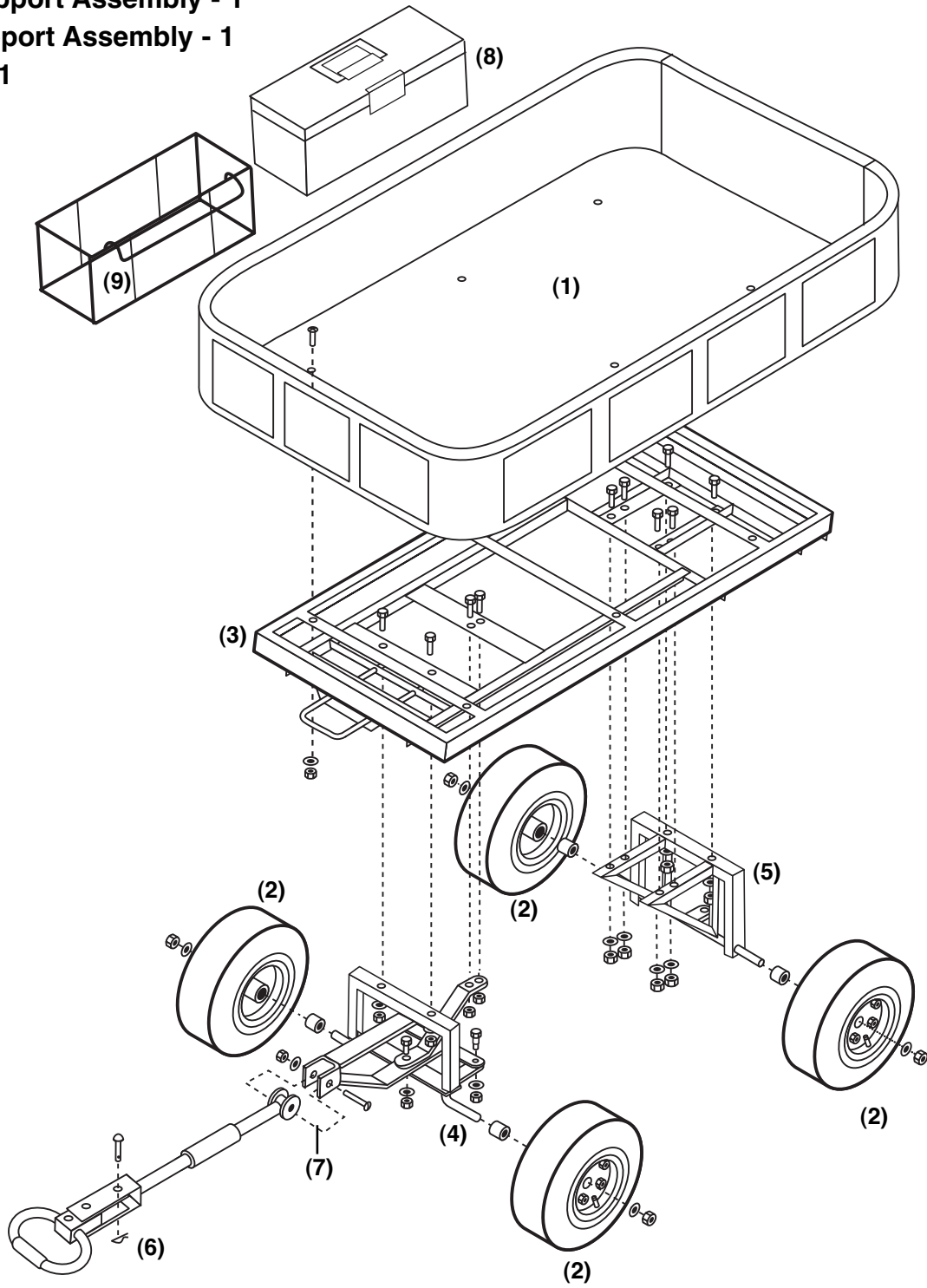

CAUTION

DO NOT EXCEED MAXIMUM OVERALL LOAD CAPACITY 1000 LBS.
MAXIMUM DUMPING LOAD CAPACITY 400 LBS.