

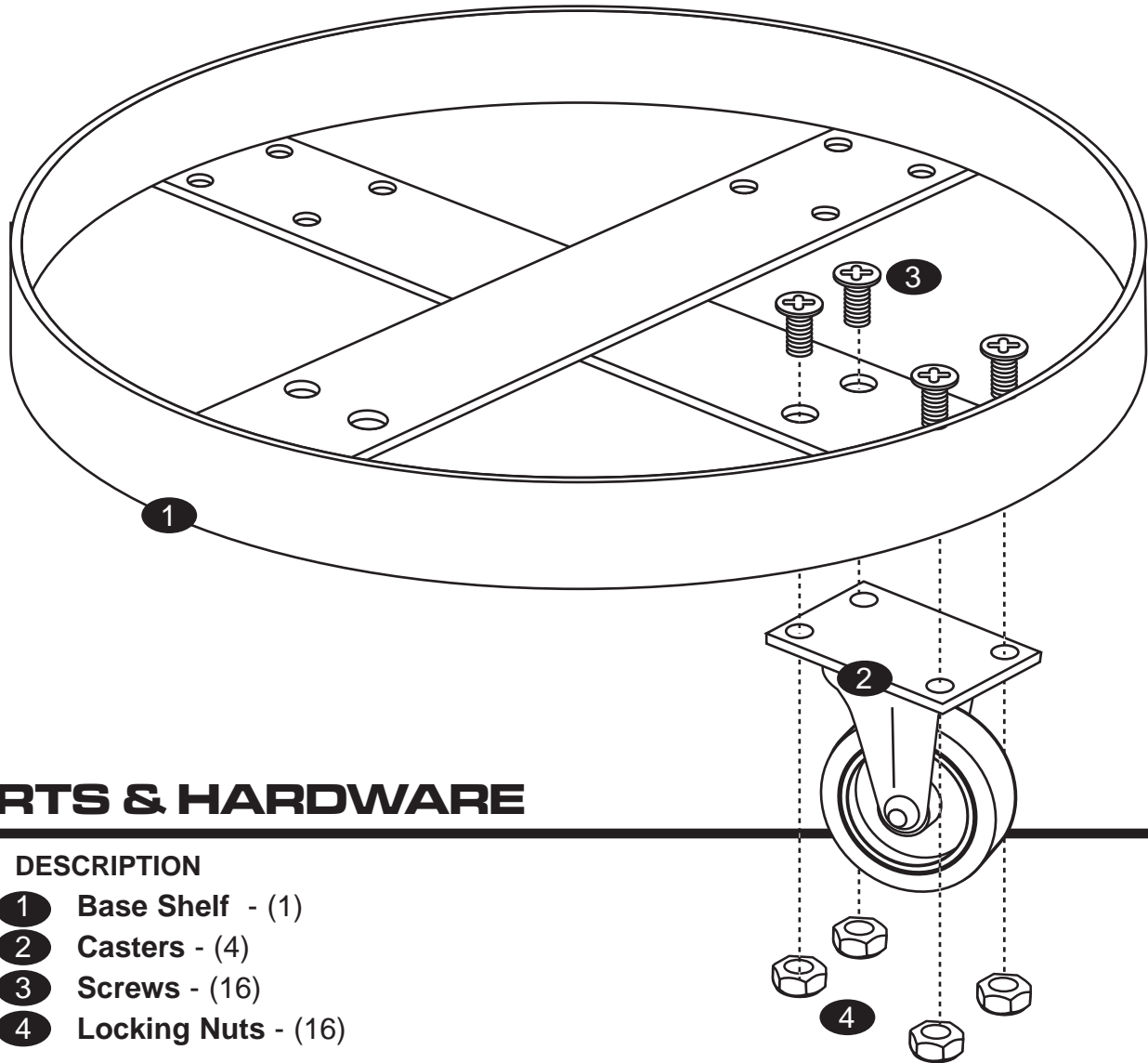

# ASSEMBLY INSTRUCTIONS

Model MH1300



## PARTS & HARDWARE

### DESCRIPTION

- 1 Base Shelf - (1)
- 2 Casters - (4)
- 3 Screws - (16)
- 4 Locking Nuts - (16)

## **!** CAUTION

Do not exceed the maximum load capacity of 440 lbs. Intended use is for drums only.

# 55-Gallon *Drum Dolly*

Tricam International  
7677 Equitable Drive  
Minneapolis, MN 55344  
800-304-1316