

CAUTION

DO NOT EXCEED MAXIMUM OVERALL LOAD CAPACITY 1,500 LBS (680 KG). PERSON SHOULD NEVER RIDE IN THE UTILITY CART. WEIGHT RATING IS BASED ON AN EVENLY DISTRIBUTED LOAD.

Replacement Parts List

For replacement parts, please visit us online at www.tricam.com to complete the replacement parts submission form or call our customer service department at 1-800-867-6763, 9 a.m. - 4 p.m., CST, Monday - Friday.

- | | |
|----------------------------|-------------------------------------|
| B. Front Bar | I. Trailer Hitch |
| C. Front Axle Sub-Assembly | J. Side Panels (8) |
| D. Front Struts (2) | K. Front/Rear Panels (2) |
| E. Square Tubes (2) | L. Left Anlged Support Bracket (2) |
| F. Rear Struts (2) | M. Right Anlged Support Bracket (2) |
| G. Rear Axle Assembly | N. Hardware Kit |
| H. Wheels (4) | |

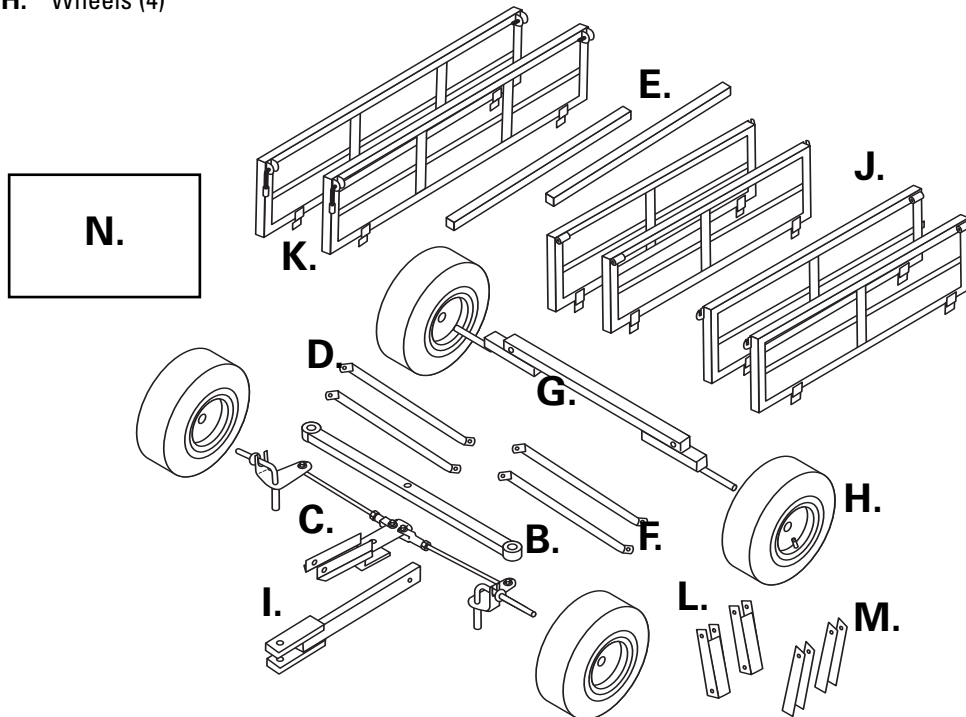

PRO SERIES Utility Trailer



Owners Manual Model GW1100-2

U.S. Patent #'s: 6,962,370 & 7,175,205
Other U.S. and Foreign Patents Pending

- Important Safety Instructions
- Assembly Instructions
- Parts and Hardware Identification

CAUTION: Read, understand and follow ALL instructions before using this product.

WARNING: Not for recreational use. Persons should never ride in the Utility Trailer.

Questions, problems, or missing parts? Before returning to your retailer, visit us online at www.tricam.com and complete the replacement parts submission form or call our customer service department at 1-800-867-6763, 9 a.m. - 4 p.m., CST, Monday-Friday.

For product inquiries:
Tricam
7677 Equitable Drive
Eden Prairie, MN 55344
800-867-6763
www.tricam.com

Exploded Drawing for Assembly

Parts List

- A. Bed (2)
- B. Front Bar (1)
- C. Front Axle Sub-Assembly (1)
- D. Front Struts (2)
- E. Square Tubes (2)
- F. Rear Struts (2)
- G. Rear Axle Assembly (1)
- H. Wheels (4)
- I. Trailer Hitch (1)
- J. Side Panels (4)-2 sets
- K. Front/Rear Panels (2)

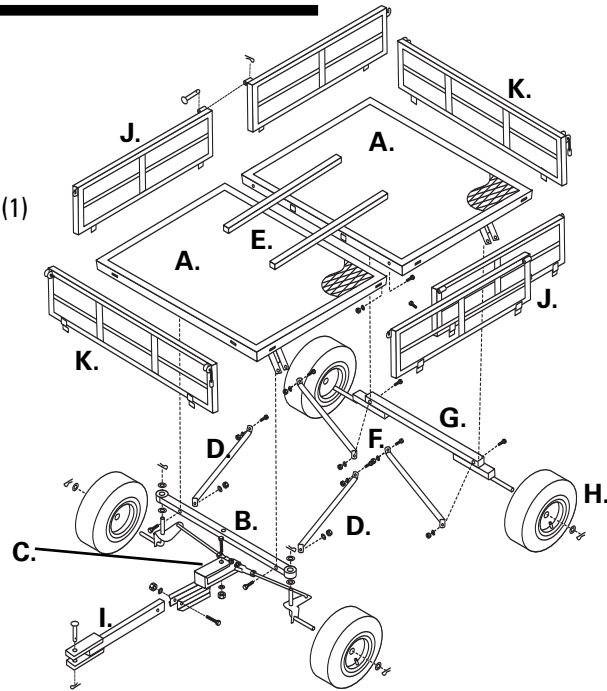

Step 15

Attach the front and rear panels to the bed.

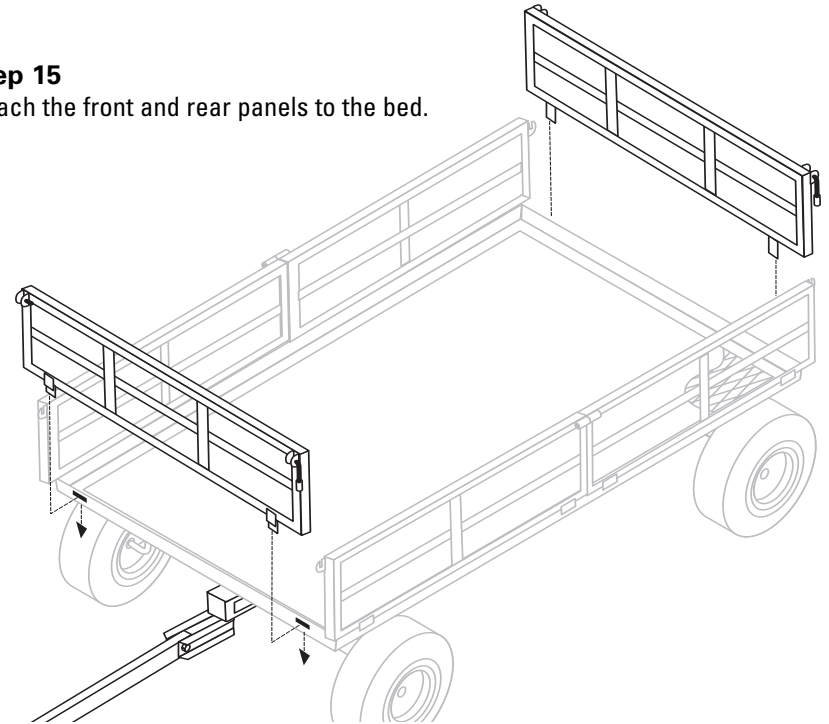

Hardware List

- A. Panel Pins (2)
- B. Pin Clips (2)
- C. M12x60 Bolt (4)
- D. M12 Washers (5)
- E. M12 Lock Nuts (5)
- F. M20 Washers (8)
- G. Cotter Pins (6)
- H. M10x70 Bolts (4)
- I. M10 Washers (6)
- J. M10 Lock Nuts (6)
- K. M10x20 Bolts (2)
- L. M12x75 Bolt (1)

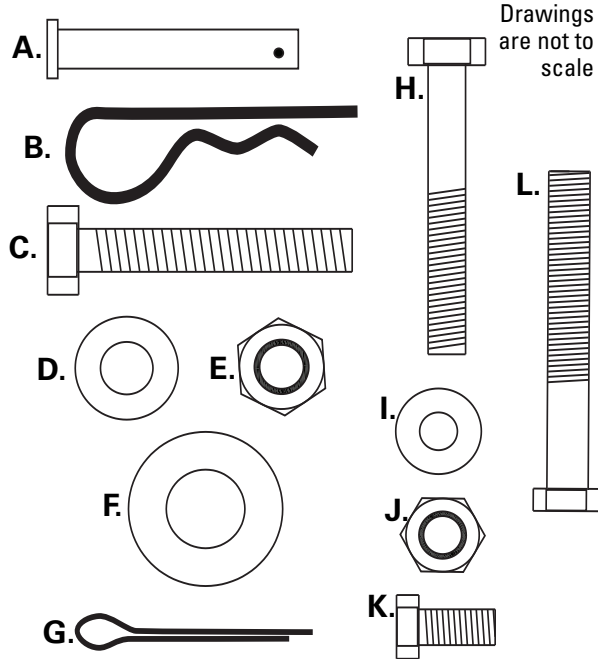

Step 16

The lock handles are pre-assembled on to the front and rear panels at the factory.
NOTE: DO not tighten the lock nuts on the lock handles until the end of this step.
 Attach the front and rear panels to the side panels by rotating the lock handles into place. Once the panels are locked together in the upright position, tighten the lock nuts on the lock handles for smooth operation without being overly tight.

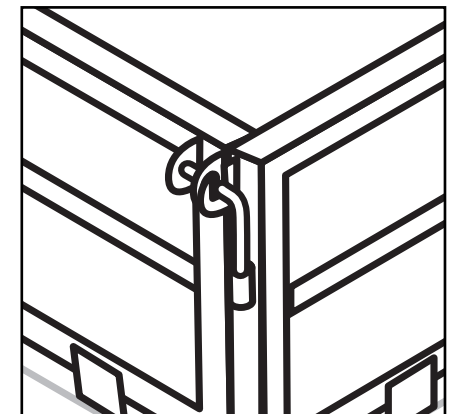
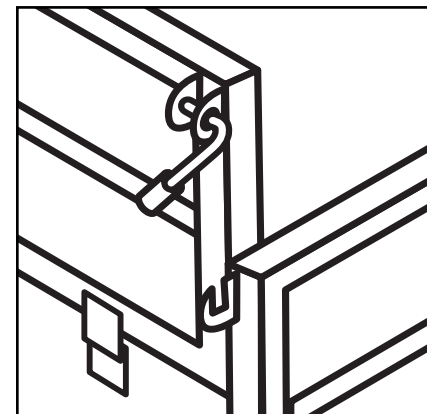

Step 10

Attach the rear axle assembly and rear struts to the angled support bars using the M10x70 bolts (2), M10 washers (2), and M10 lock nuts (2).

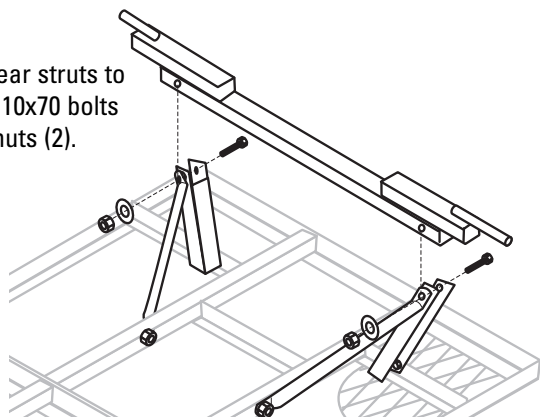

Step 11

Attach the wheels onto the front and rear axle assemblies. Place the M20 washers (4) onto the axles on the outside of each wheel. Insert the large cotter pins (4) through the holes at the end of each axle and bend back the ends of the cotter pins to keep them in place.

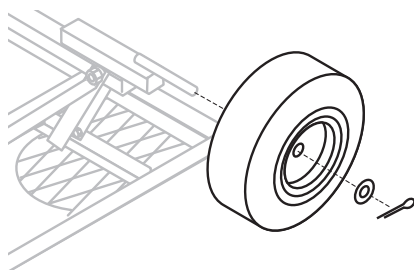

Step 12

Turn the utility trailer upright onto its wheels.

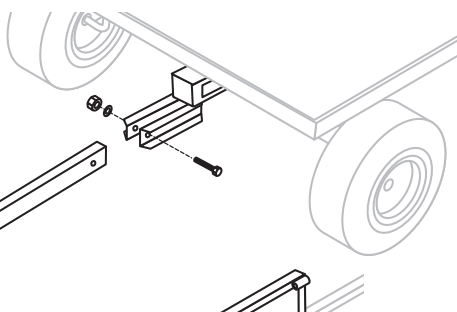

Step 13

Attach the trailer hitch to the front axle assembly using M12x60 bolt (1), M12 washer (1), and M12 lock nut, which are pre-assembled to the front axle assembly.

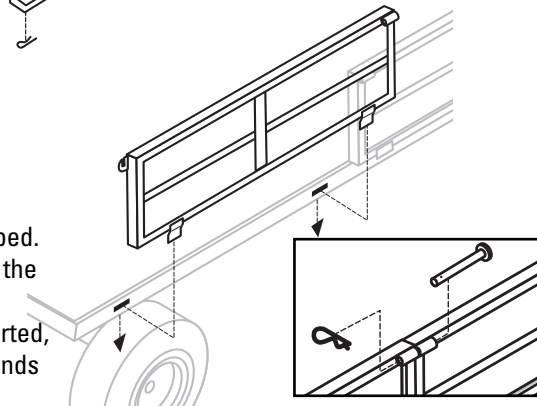

Step 14

Attach the side panels (4) onto the bed. Secure the side panels by inserting the pins through the holes on the side panels. Once the pins are fully inserted, secure by placing the clips on the ends of the pins.

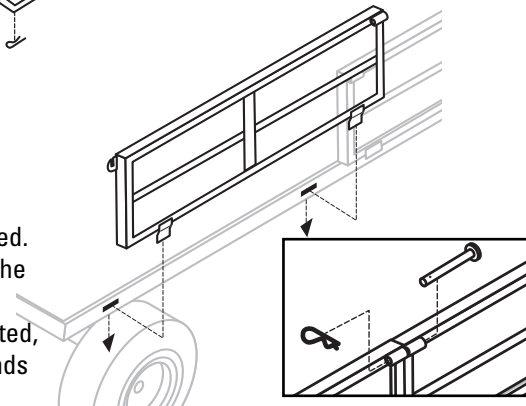

Important Safety Instructions

1. READ ALL INSTRUCTIONS CAREFULLY BEFORE USE. If you do not understand these instructions, need clarification or further explanation, please call our toll free answer line for assistance at 1-800-867-6763 Monday through Friday 9:00 a.m. - 4:00 p.m., CST.
2. Do not exceed the overall maximum load capacity of 1,500 lbs (680 kg). The weight rating is based on an evenly distributed load.
3. Do not load items on the top edges of the panels. Remove panels before loading oversized items.
4. Do not allow children to use this utility trailer without supervision. This utility trailer is not a toy.
5. Do not use this utility trailer to transport passengers.
6. This utility trailer is not intended for highway use.
7. Do not exceed 5 mph.
8. If any parts become damaged, broken or misplaced, do not use the utility trailer until replacement parts have been obtained.
9. Do not use the utility trailer on surfaces or for transporting objects that can cause damage to the pneumatic tires or tubes.
Do not inflate the tires to more than 30 PSI (2.07 BAR).
10. It is recommended that the cart be inspected for damage before each use.
11. KEEP THESE INSTRUCTIONS FOR FURTHER REFERENCE.

Assembly Instructions

Your utility trailer requires assembly. Account for all parts before beginning assembly. If any parts are missing, damaged, or if you have any questions or need additional instructions, DO NOT RETURN THIS PRODUCT TO THE RETAILER, visit us at www.tricam.com to complete the replacement parts submission form or call our customer service department at 1-800-867-6763.

Tools required for assembly: 10, 12, 20mm open end wrench and/or two medium adjustable wrenches. Refer to the exploded drawing and the parts list on the following pages during assembly.

NOTE: During each step of assembly, assemble all hardware and hand tighten. Once all the hardware is installed for that particular step, tighten all hardware.



Due to the size and weight of the utility trailer, it is recommended that 2 people are used for some assembly steps.

Step 1

Turn the cart beds upside down. Use the cardboard from the carton to keep from scratching or damaging the finish.

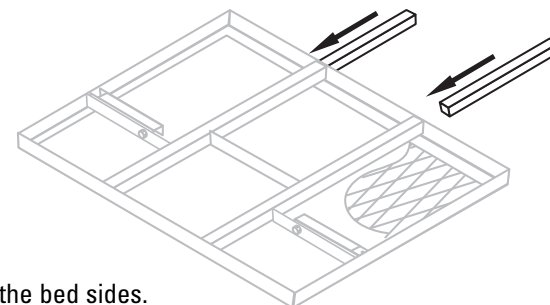

Step 2

Insert the square tubes into one of the bed sides.

Step 3

Attach the front struts (2) to the bed using M12x60 bolts (2), M12 washers (2), and M12 lock nuts (2).

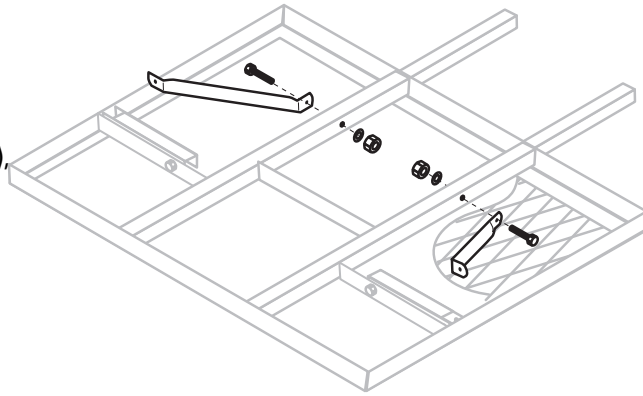

Step 4

A) Assemble the front bar to the front axle sub-assembly using M20 washers (4) and cotter pins (2), which have been pre-assembled onto the front axle sub-assembly.

B) Insert the M12x75 bolt (1) through the hole of the front axle sub-assembly and the front bar. Add the M12 washer (1) and M12 lock nut (1). Tighten securely. Set this front axle assembly aside for Step 7.

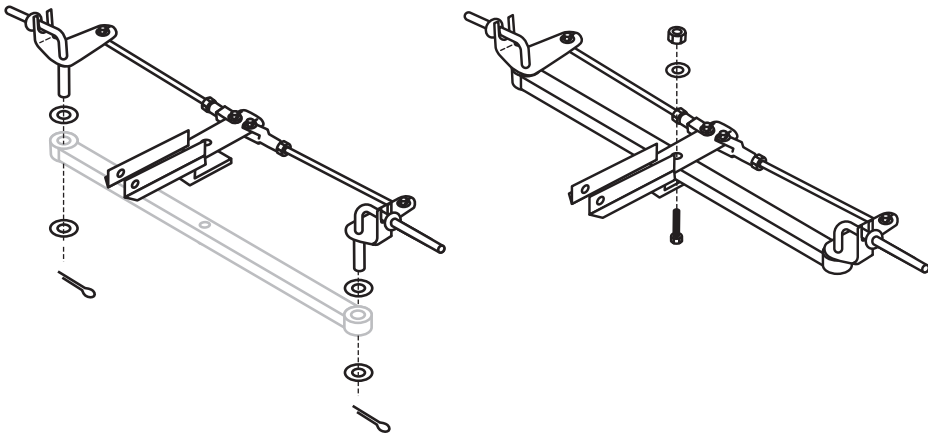

Step 5

The angled support brackets have been pre-assembled to the bed. Pivot them up so that they are at a 75 degree angle pointing towards the outside edge of the bed and hand-tighten the lock nuts. Do not over-tighten the lock nuts in this step. You will want to be able to move the angled brackets back and forth slightly for the next step.

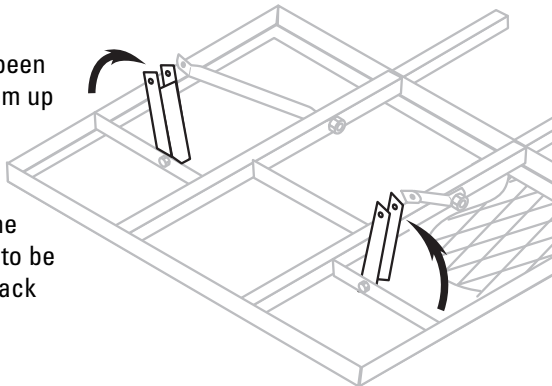

Step 6

Attach the front axle assembly and front struts to the angled support bars using the M10x70 bolts (2), M10 washers (2), and M10 lock nuts (2).

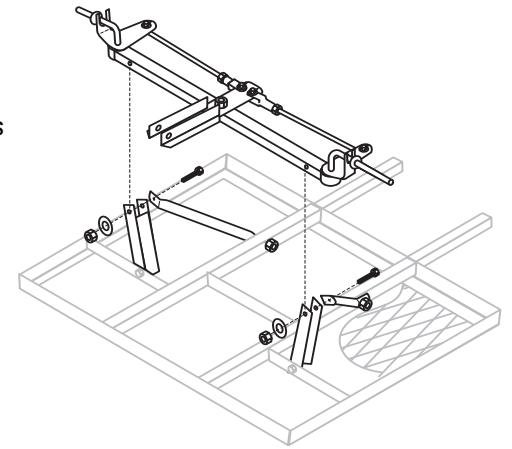

Step 7

Slide the other side of the bed onto the square tubes. Secure the two beds together at the ends using M10x20 bolts (2), M10 washers (2), and M10 lock nuts (2).

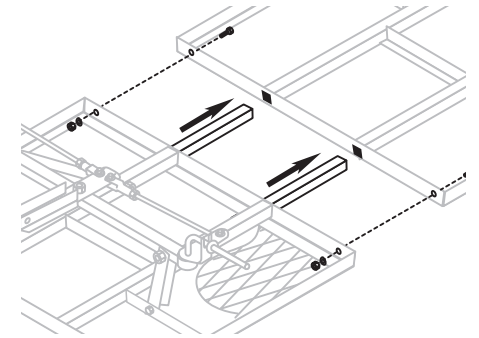

Step 8

Attach the rear struts to the rear bed using M12x60 bolts (2), M12 washers (2), and M12 lock nuts (2).

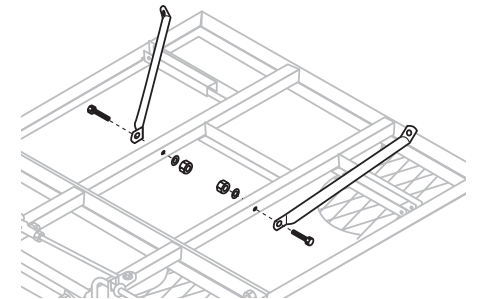

Step 9

The angled support brackets have been pre-assembled to the bed. Pivot them up so that they are at a 75 degree angle pointing towards the outside edge of the bed and hand-tighten the lock nuts. Do not over-tighten the lock nuts in this step. You will want to be able to move the angled brackets back and forth slightly for the next step.

