



# OWNER'S MANUAL

Model MH1060-01



- Important Safety Instructions
- Assembly Instructions
- Parts and Hardware Identification

## *Tricycle*

### **CAUTION:**

Read, understand and follow ALL instructions before using this product

**RMM Corporation**  
**7677 Equitable Drive**  
**Minneapolis, MN 55344**  
**800-304-1316**  
**[www.black-cat-products.com](http://www.black-cat-products.com)**

REV 7/05

# IMPORTANT SAFETY INSTRUCTIONS

---

1. **READ ALL INSTRUCTIONS CAREFULLY BEFORE USE.** If you do not understand these instructions, need clarification or further explanation, please call our toll free answer line for assistance at **1-800-304-1316** Monday through Friday 8:00 a.m. until 5:00 p.m. CST.
2. This tricycle is intended to hold up to 180 lbs. maximum capacity.
3. If any parts become damaged, broken or misplaced do not use the Tricycle until replacement parts can be obtained.
4. Do not operate or use the Tricycle on objects that can cause damage to the pneumatic tires or tubes.
5. Do not inflate the tires to more than 30 psi (rear tires) or 35 psi (front tire).
7. **SAVE THESE INSTRUCTIONS.**

## ASSEMBLY INSTRUCTIONS

---

Your Tricycle requires assembly. Account for all parts and hardware before beginning assembly. If any parts are missing, damaged, or if you have any questions or need additional instructions, **DO NOT RETURN THIS PRODUCT TO THE RETAILER**, call the manufacturer at **1-800-304-1316**.

Refer to the exploded drawing and the parts list on the following pages during assembly.

---

**STEP 1** Attach the main frame to the front tire. The hardware to do this comes pre-assembled onto the front tire. Loosen the threaded nut (silver), threaded washer (silver), and the top bearing from the post of the front tire, being careful to keep the same orientation. Leave the remaining bearing and bushing on the front tire post. Slip the front end of the main frame over the tire post making sure the main frame is in the upright position. Replace the bushing, threaded washer and threaded nut and tighten completely.

**STEP 2** Insert the handle bar stem into the main frame and tighten the threaded fork stem nut. Make sure that the handle bars and the front tire are in proper alignment.

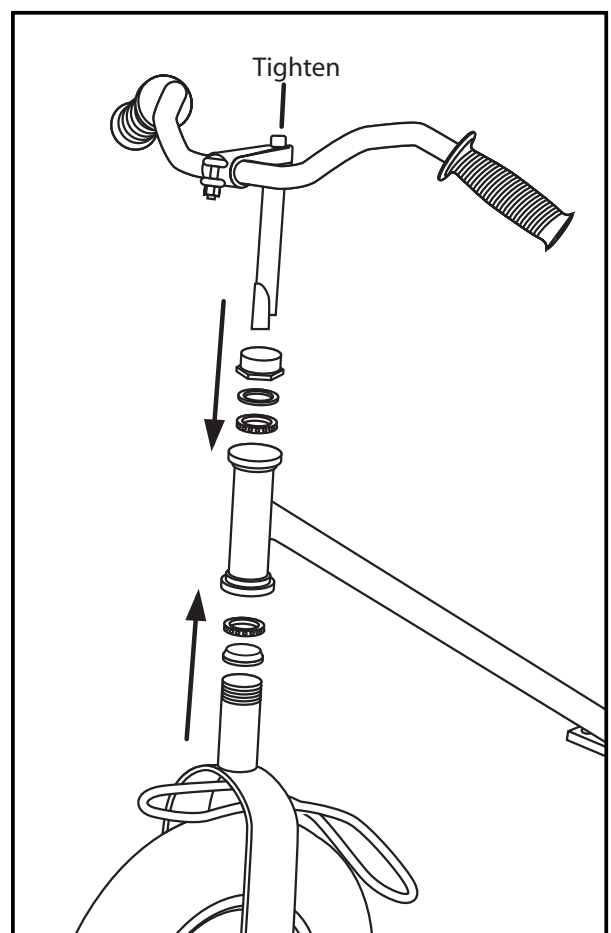

**STEP 3** Attach the main frame to the rear plate assembly using the (4) rear plate bolts, (8) washers and rear plate nuts. Tighten securely.

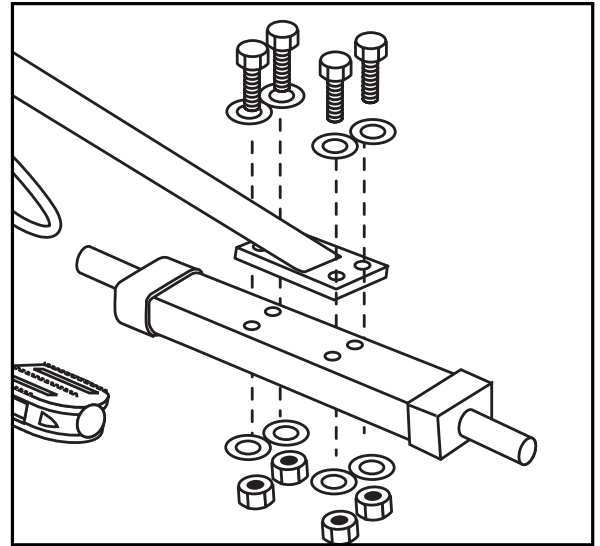

**STEP 4** Place one 10" tire onto the axle of the rear plate assembly. Place a washer on the axle and insert cotter pin into the end of the axle. Duplicate this step for the left side tire.

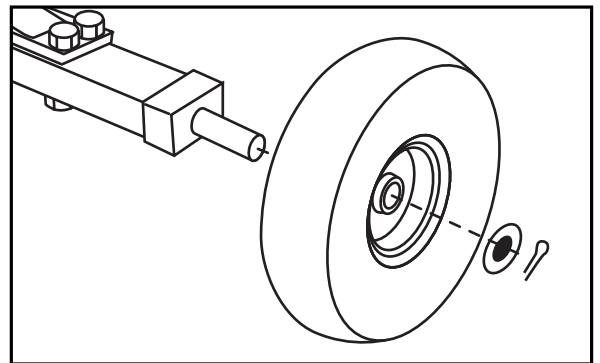

**STEP 5** Assemble the seat by loosening the 3/8" hex head bolts, washers, and nuts and inserting the seat onto the main frame assembly. The seat height can be adjusted by simply moving the seat up or down to the desired height. Once at the proper height, simply tighten the hex head nuts.

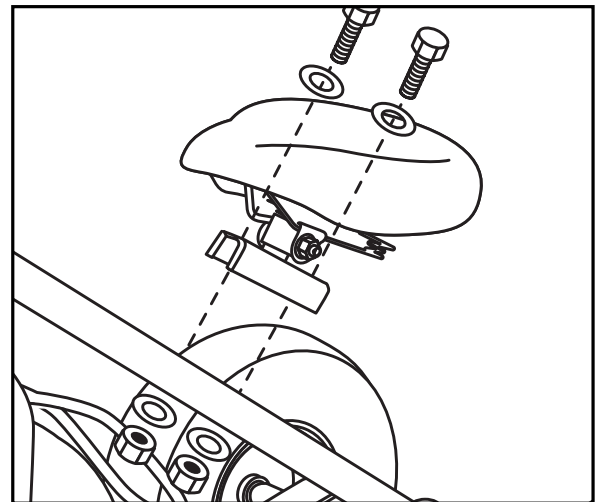

**STEP 6** The seat can also be moved forward or backward simply by taking off the nuts, and washers and bolts holding the seat bracket. Move the bracket forward or backward to the desired position and re-insert the bolts and attach the nuts.

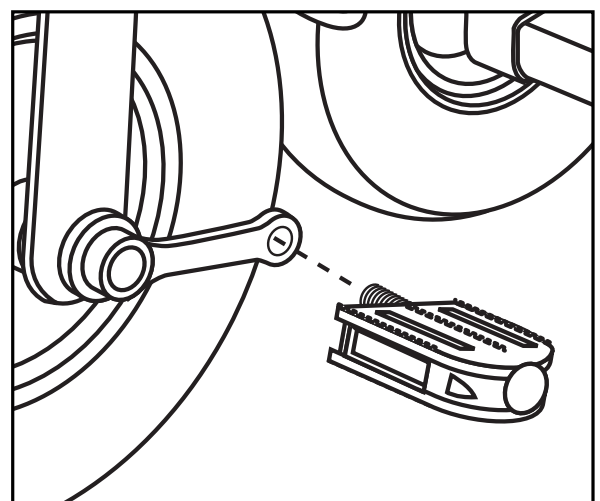

**STEP 7** The pedals are shipped attached to the correct pedal arms on the front tire. Unpack the pedals and thread them onto the pedal arms. Tighten completely.

**STEP 8** Test the tricycle by checking all fasteners for tightness. Roll the tricycle to check for proper wheel operation.

# PARTS AND HARDWARE IDENTIFICATION

- |   |                        |    |                          |
|---|------------------------|----|--------------------------|
| 1 | Handle Bar (1)         | 10 | Seat Bracket Nuts (2)    |
| 2 | Handle Bar Grips (2)   | 11 | Seat Bracket Washers (4) |
| 3 | Main Frame (1)         | 12 | Pedals (2)               |
| 4 | 13" Tire (1)           | 13 | Cotter Pins (2)          |
| 5 | 10" Tires (2)          | 14 | Rear Plate Assembly (1)  |
| 6 | Washers (2)            | 15 | Rear Plate Bolts (4)     |
| 7 | Seat (1)               | 16 | Rear Plate Nuts (4)      |
| 8 | Seat Bracket (1)       | 17 | Rear Plate Washers (8)   |
| 9 | Seat Bracket Bolts (2) |    |                          |

