



## MULTI-USE DUMP CART

### OWNER'S MANUAL



#### **WARNING:**

Read carefully and understand all **ASSEMBLY AND OPERATION INSTRUCTIONS** before operating. Failure to follow the safety rules and other basic safety precautions may result in serious personal injury.

Item# 46530

Thank you very much for choosing a Strongway product! For future reference, please complete the owner's record below:

Model: \_\_\_\_\_ Purchase Date: \_\_\_\_\_

Save the receipt, warranty and these instructions. It is important that you read the entire manual to become familiar with this product before you begin using it.

This cart is designed for certain applications only. The distributor cannot be responsible for issues arising from modification. Do not modify this cart or use it for any application other than that for which it was designed.

For technical questions please call **1-800-222-5381**.

## INTENDED USE

Perfect for hauling oversized loads such as firewood, rock, mulch and dirt.

## TECHNICAL SPECIFICATIONS

Item	Description
Capacity	Overall maximum 1,200 lbs. load capacity Maximum 500 lbs. dumping load capacity when cart is loaded.
Tires	13 inch Pneumatic Tires Do not inflate the tires to more than 30 PSI.
Construction	Steel frame with poly bed tray
Dimensions	44 x 24 x 24.75

## GENERAL SAFETY RULES



**WARNING:** Read and understand all instructions. Failure to follow all instructions listed below may result in serious injury.



**CAUTION:** Do not allow persons to operate or assemble this multi-use dump cart until they have read this manual and have developed a thorough understanding of how the multi-use dump cart works.



**WARNING:** The warnings, cautions, and instructions discussed in this instruction manual cannot cover all possible conditions or situations that could occur. It must be understood by the operator that common sense and caution are factors which cannot be built into this product, but must be supplied by the operator.

## SAVE THESE INSTRUCTIONS

## IMPORTANT SAFETY CONSIDERATIONS

- **Do not exceed loading capacity.**
  - **Maximum load capacity:** 1,200 lbs.
  - **Maximum dumping load capacity:** 500 lbs.
- **Distribute load over the surface of the tray.** Do not load items on the top edges of the tray.
- **Do not modify the cart in any way.** Unauthorized modification may impair the function and/or safety and could affect the life of the equipment. There are specific applications for which the multi-use dump cart was designed.
- **This cart is not intended for highway use.** Do not exceed 5 mph.
- **Do not use this cart for transporting passengers.** Do not allow children to use this cart without supervision. This cart is not a toy.
- **Do not inflate the tires to more than 30 PSI.** Do not use the cart on surfaces or for transporting objects that can cause damage to the pneumatic tires.
- **Always check of damaged or worn out parts before using the cart.** Broken parts will affect the cart operation. Replace or repair damaged or worn parts immediately.
- **Store idle the cart .**When cart is not in use, store it in a secure place out of the reach of children. Inspect it for good working condition prior to storage and before re-use.

## EXPLODED DRAWING FOR ASSEMBLY

### PARTS LIST

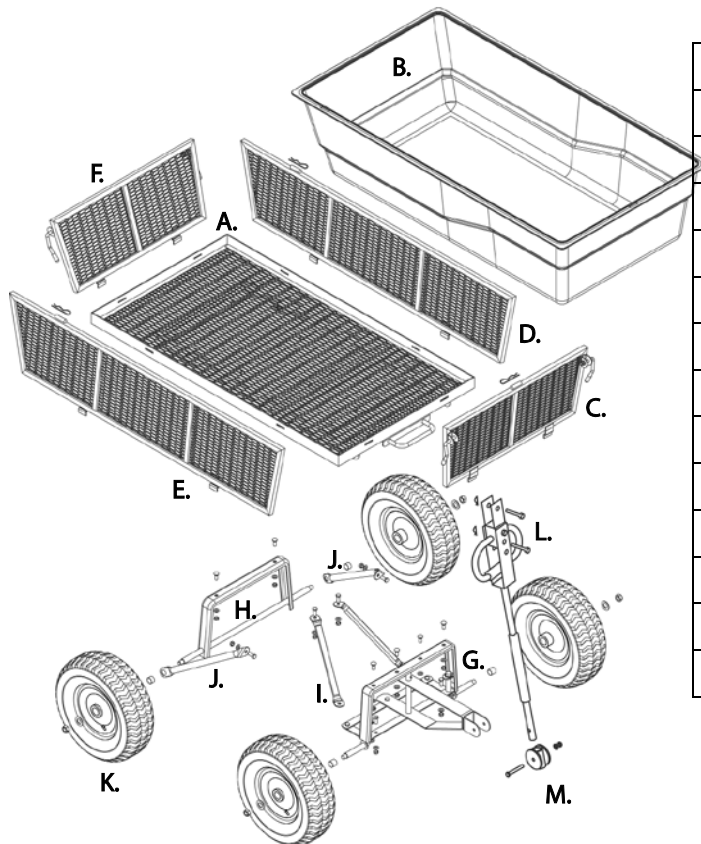

Part#	Description	Qty.
A.	Bed Frame	1
B.	Poly Liner / Cover	1
C.	Front Panel	1
D.	Left Panel	1
E.	Right Panel	1
F.	Back Panel	1
G.	Front Axle Assembly	1
H.	Rear Axle Assembly	1
I.	Front Struts	2
J.	Rear Struts	2
K.	Wheels	4
L.	Handle	1
M.	Coupling	1

### Hardware List

- A. M8X60 Hex Head Bolt (1)
- B. M8X20 Carriage Head Bolt (10)
- C. M8X20 Hex Head Bolt (2)
- D. M8 Flat Washer (13)
- E. M8 Lock Nut (13)
- F. M12 Wheel Spacer (4)
- G. M12 Flat Washer (4)
- H. M12 Lock Nut (4)
- I. Assembly Pins (3)

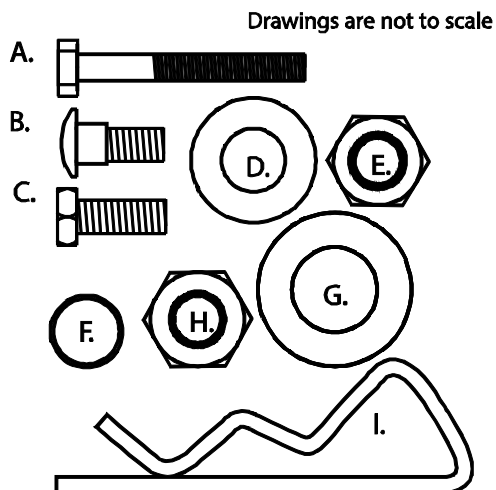

## ASSEMBLY

1. Turn the cart bed frame assembly upside down. Use the cardboard from the carton to keep from scratching or damaging the finish. The front frame is pre-assembled to the cart bed frame.

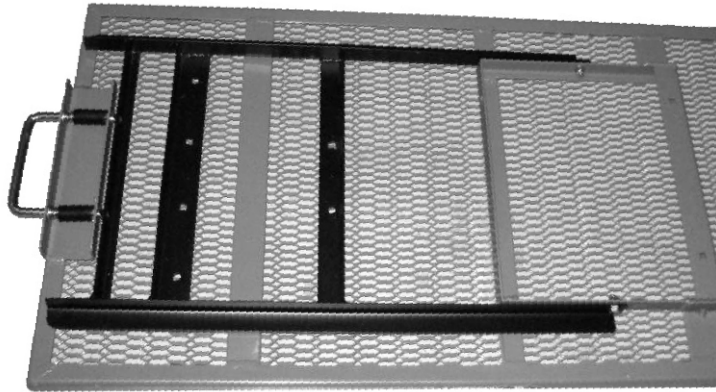

2. Unlock the front frame by pulling the handle out and place the rear axle assembly under the frame to prop it up for easier access.

Attach the front axle assembly to the bed frame using M8x20 carriage bolts (4) M8 flat washers (4) and M8 lock nuts (4). The bolts should go through the frame first and then the front axle assembly.

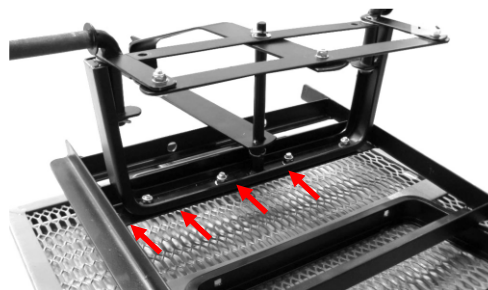
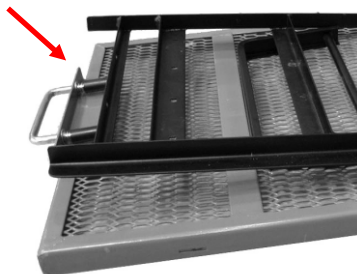

3. Attach the front struts (2) to the bed frame using M8x20 carriage bolts (2), M8 flat washers (2), and M8 lock nuts (2). Slide the M8x20 carriage bolts through the bed frame first and then through the struts.

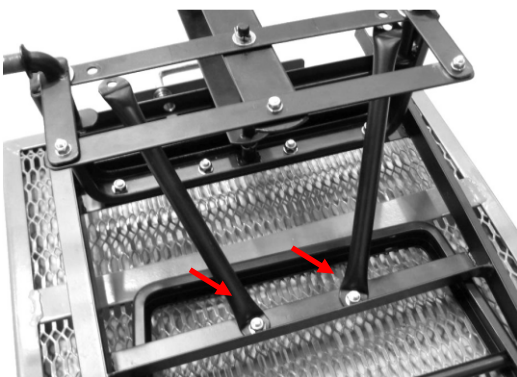

4. Next attach the front struts (2) to the underside of the front axle assembly using M8x20 hex head bolts (2), M8 flat washers (2), and M8 lock nuts (2). Tighten all hardware securely.

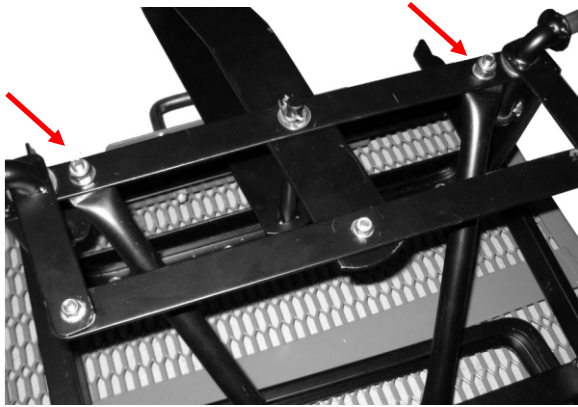

5. Attach the rear axle assembly to the bed frame using M8x20 carriage bolts (2), M8 flat washers (2), and M8 lock nuts (2). Hand tighten.

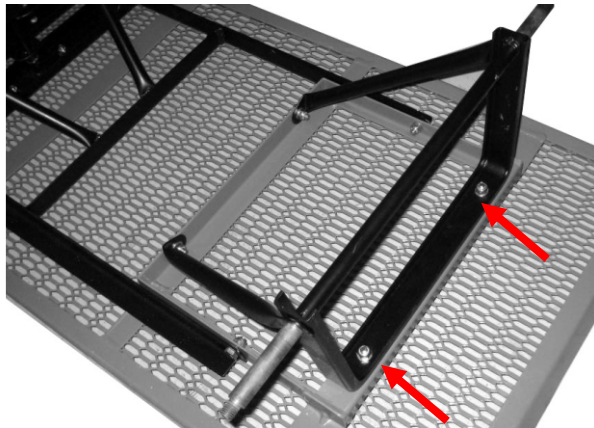

6. Slide the rear struts onto the rear axle assembly and attach the angled part of the strut to the bed frame using M8x20 carriage bolts (2), M8 flat washers (2), and M8 lock nuts (2). Tighten all hardware securely.

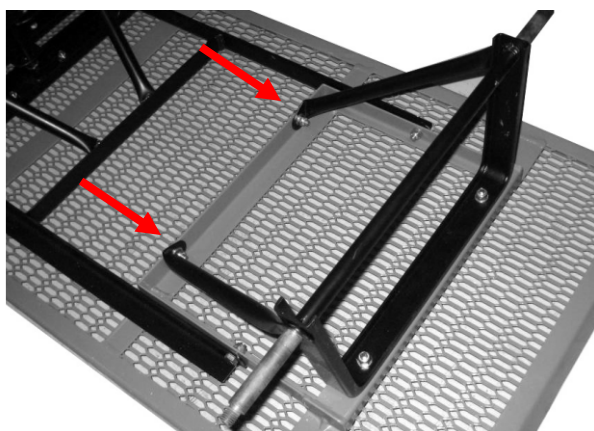

7. Attach the wheels to the cart by first placing the wheel spacers (4) onto the front and rear axles.

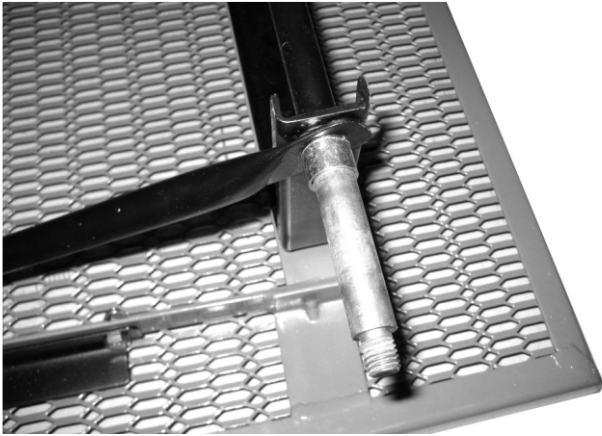

8. Place the wheels onto each axle (valve stems facing out) using the M12 flat washers (4) and M12 lock nuts (4). Tighten all nuts securely. Turn cart upright.



9. Attach the mesh panels to the side of the bed frame. Each panel has a letter stamped on it (L, R, F, B) that corresponds to the same letters stamped on the bed frame itself.

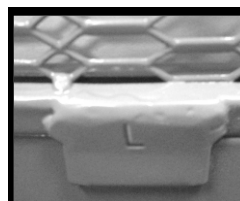

10. Insert the plastic tray by lining up the openings on the rim of the tray with the tabs on the top edges of the side panels. Lock the tray in place by sliding cotter pins through the tabs. The plastic tray can also be used as a cover / work surface. Lock the tray by sliding the cotter pins through the tabs.



11. Attach handle to the yoke using M8x60 bolt (1), M8 flat washer (1), and M8 lock nut (1). Tighten securely.

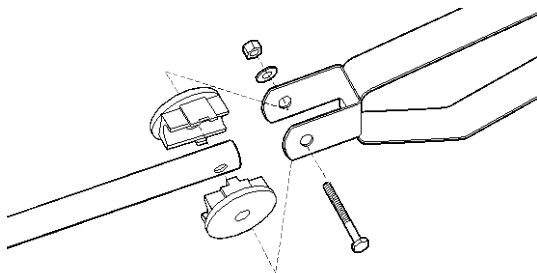

## OPERATION

Distribute the load evenly over the surface of the tray.

Do not load items on the top edges of the tray.

### USING THE SWIVEL HANDLE

1. Remove clips and cotter pins.
2. Rotate the handle and insert cotter pin. Secure by attaching the clip.
3. The second cotter pin is used to attach the handle to the trailer hitch.

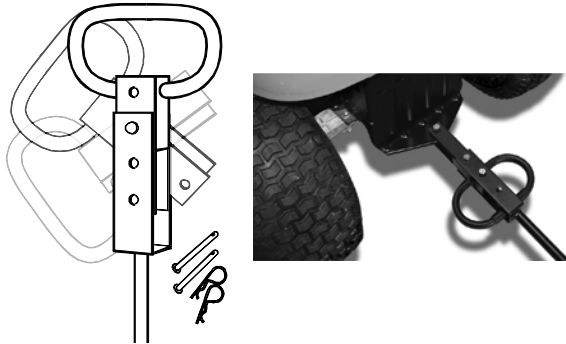

### USING THE DUMPING FEATURE

To use the dumping feature, pull the dumping release handle forward in order to release the tray from the locking mechanism. Lift the release handle in order to rotate the tray upward into the dumping position.

**WARNING:** To reduce risk of injury when dumping, ensure worksite is clear and free of hazards and bystanders.

### RETURNING THE TRAY TO THE LOWERED POSITION

Return the tray back to the lowered position and verify that the dumping release handle locks in place. Avoid pinch points.

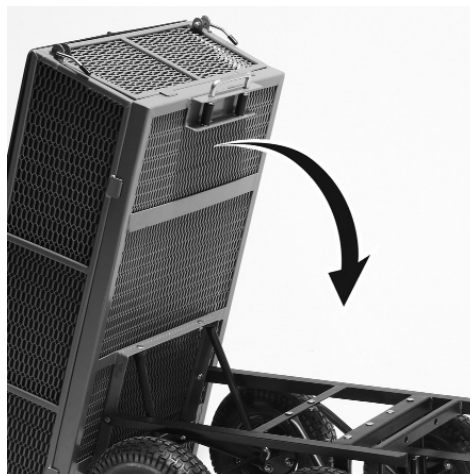

## MAINTENANCE

- **Maintain your cart.** It is recommended that the general condition of any cart be examined before it is used. Keep your cart in good repair by adopting a program of conscientious repair and maintenance. Have necessary repairs made by qualified service personnel.

## DIAGRAM & REPLACEMENT PARTS LIST

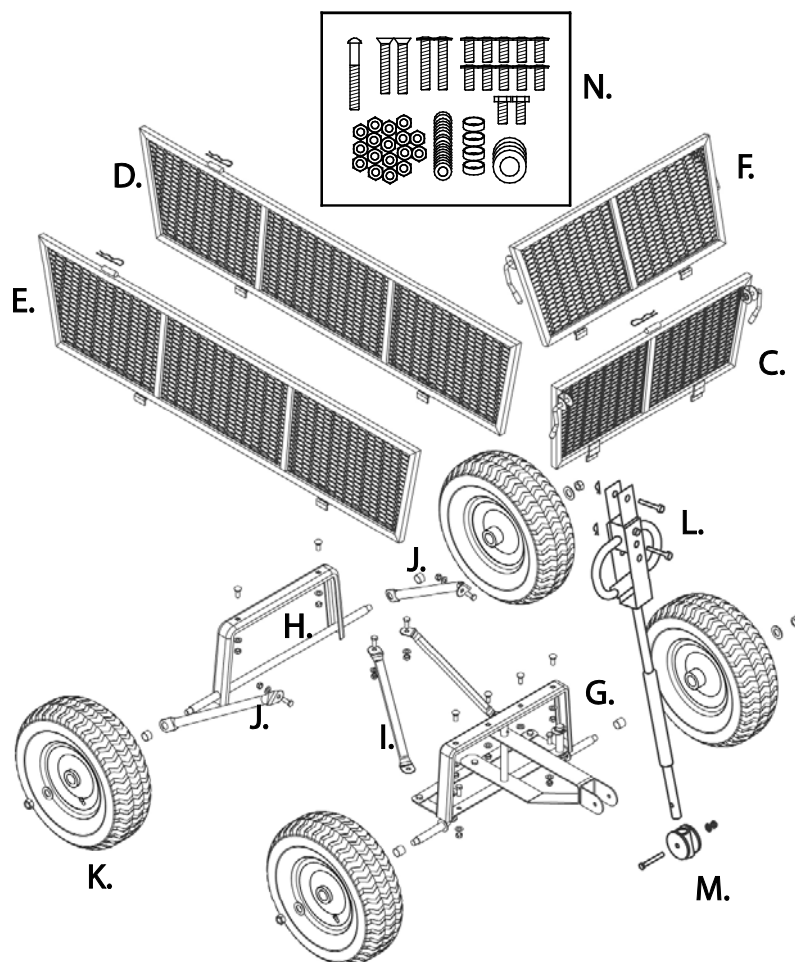

Part#	Description	Qty.
C.	Front Panel	1
D.	Left Panel	1
E.	Right Panel	1
F.	Back Panel	1
G.	Front Axle Assembly	1
H.	Rear Axle Assembly	1
I.	Front Struts	2
J.	Rear Struts	2
K.	Wheels	4
L.	Handle	1
M.	Coupling	1
N.	Hardware Kit	1

For replacement parts and technical questions, please call **1-800-222-5381**.

## **WARRANTY**

### **1-Year Limited Warranty**



Distributed by  
Northern Tool + Equipment Co., Inc.  
Burnsville, Minnesota 55306  
NorthernTool.com  
Made in China